

SHW42-09 Series □ 42 mm

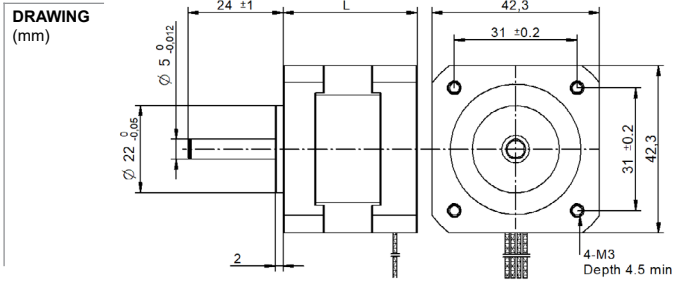

PHOTO



MODEL NAME DESIGNATION

SHW3520 - STEP ANGLE - CURRENT

Example: SHW35-09-100



OPTIONS MOTOR DRIVERS AND POWER SUPPLIES



MOTOR FEATURES

Step angle	0.9
Step angle accuracy	± 5% full step no load
Shaft material	X8CrNiS18-9 303
Bearing type	Ball bearing
Radial play	0.02 mm 450 g
Axial play	0.08 mm 450 g
Max. radial force	28N 20 mm from shaft
Max. axial force	10N
Dielectric strength	600VAC 1 sec.
Insulation resistance	100MΩ 500VDC
Ambient temperature	-20° - (+50°)
Insulation class	Class B
IP rating	IP30
Connection leads	UL 1430 AWG26 300 mm
Connector	No

CUSTOMIZATION EXAMPLES

- Shaft configurations
- Bearing type and preload
- Temperature range
- IP rating
- Winding and performance optimization
- Cabling and harness
- Gear box to motor combinations
- Encoder to motor combinations

OPTIONS

- Stepper motor drivers Transmotec DS series
- Power supplies Transmotec LRS series

EXCITATION SEQUENCE TABLE

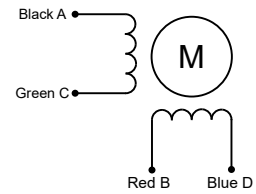

CW	A	C	B	D
1	●		●	
2		●	●	
3		●		●
4	●			●
1	●		●	

● = + Polarity

MOTOR DATA

Graph	A	B	
Motor model	SHW4234-09-133	SHW4240-09-168	SHW4247-09-168
Holding torque mNm	0.220	0.330	0.440
Detent torque Nm	0.0200	0.0220	0.0250
Rotor inertia gcm ²	35	54	68
Current phase A	1.33	1.68	1.68
Resistance phase Ω	2.10	1.80	1.80
Inductance mH	4.2	4.1	5
Length mm	33.5	39.5	47.5
Weight Kg	0.200	0.220	0.250

SPEED | TORQUE PERFORMANCE GRAPH PULL OUT

Graph	A	B	C
Supply voltage VDC	36	36	36
Current phase A	1.36	1.69	1.69

