

SHW35-09 Series 35 mm

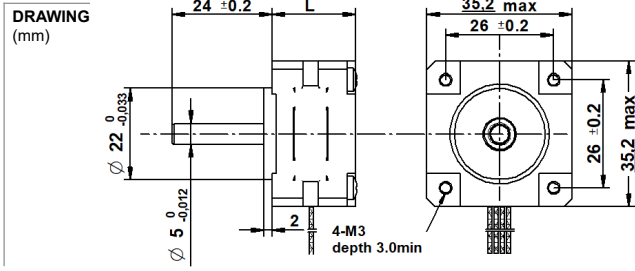

PHOTO



MODEL NAME DESIGNATION

SHW3520 - STEP ANGLE - CURRENT

Example: SHW35-09-100



OPTIONS MOTOR DRIVERS AND POWER SUPPLIES



MOTOR FEATURES	
Step angle	0.9
Step angle accuracy	± 5% full step no load
Shaft material	X8CrNiS18-9 303
Bearing type	Ball bearing
Radial play	0.02 mm 400 g
Axial play	0.08 mm 400 g
Max. radial force	26N 20 mm from shaft
Max. axial force	10N
Dielectric strength	600VAC 1 sec.
Insulation resistance	100MΩ 500VDC
Ambient temperature	-20° - (+50°)
Insulation class	Class B
IP rating	IP30
Connection leads	UL 1061 AWG26 300 mm
Connector	No

CUSTOMIZATION EXAMPLES	
Shaft configurations	
Bearing type and preload	
Temperature range	
IP rating	
Winding and performance optimization	
Cabling and harness	
Gear box to motor combinations	
Encoder to motor combinations	
OPTIONS	
Stepper motor drivers Transmotec DS series	
Power supplies Transmotec LRS series	

EXCITATION SEQUENCE TABLE

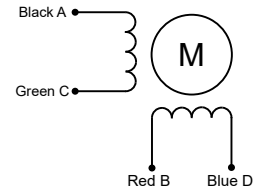

CW	A	C	B	D
1	●		●	
2		●	●	
3		●		●
4	●			●
1	●		●	

● = + Polarity

MOTOR DATA			
Graph	A	B	
Motor model	SHW3520-09-100	SHW3526-09-050	
Holding torque mNm	0.050	0.090	
Detent torque Nm	0.0050	0.0800	
Rotor inertia gcm ²	8	11	
Current phase A	1.00	0.50	
Resistance phase Ω	10.00	6.10	
Inductance mH	8.5	6.9	
Length mm	20.0	26.0	
Weight Kg	0.100	0.150	

SPEED TORQUE PERFORMANCE GRAPH PULL OUT			
Graph	A	B	
Supply voltage VDC	24	24	
Current phase A	1.0	0.5	

