

PDS132190 / Ø 132mm / 421W / 421W

DRAWING (mm)

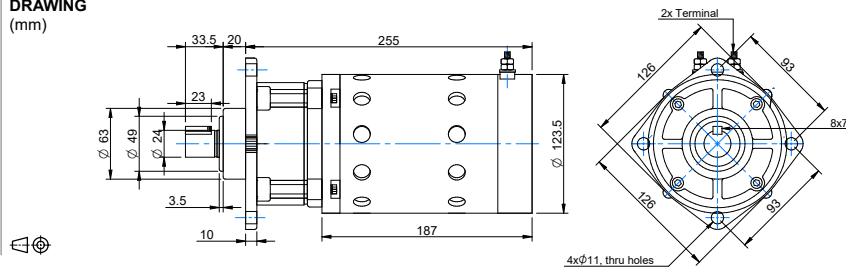

PHOTO



MODEL NO. DESIGNATION

PDS132190 - VOLTAGE - REDUCTION - B
 Example: PDS132190-12-4 B = Brake

ADDITIONAL



Brake

GEAR MOTOR DATA

Reduction	10:1
Nominal torque 12 V (Nm) *	16
Nominal speed 12 V (rpm) *	202
Nominal torque 24 V (Nm) *	16
Nominal speed 24 V (rpm) *	202
Length (mm)	255
Weight (kg)	31.5

* Nominal speed and nominal torque have a tolerance of ± 15%

GEAR HEAD DATA

Reduction	10:1
Max. continuous torque (Nm)	29.4
Intermittently permissible torque (Nm)	44.0
Efficiency (%)	80
Weight (kg)	21

GEAR MOTOR FEATURES AND STANDARD DATA

	STANDARD	CUSTOMIZATION OPTIONS
Type	Planetary gear brush dc gear motor	
Motor type	Iron core. brush commutation	Winding parameters
Motor brush type	Carbon brushes	
Motor terminals	Screw bolt terminals	Wiring harnesses. cables. connectors
EMC filter	No	Yes
Gear material	Metal	
Motor pinion material	Plastic	
Bearing	Ball bearing	
Shaft	Hardened stainless steel	Dimensions
Brake option	Electric brake (to order as option)	
Environmental protection	IP55 (with encoder or brake IP50)	
Operating temperature	-10-...+60 °C	- 40-...+60 °C
RoHS compliance	Yes	
CE label	Yes	Yes

MOTOR DATA

Nominal voltage (V)	12	24
No load speed (rpm)	2400	2400
No load current (A)	5.5	2.5
Nominal speed (rpm)	2020	2020
Nominal torque (Nm)	2	2
Nominal current (A)	43	22
Stall torque (Nm)	8.2	8.2
Starting current (A)	262	131
Output (W)	421	421
Length (mm)	187	187
Weight (kg)	10.5	10.5