

D4387 / Ø 43mm / 12W

DRAWING (mm)

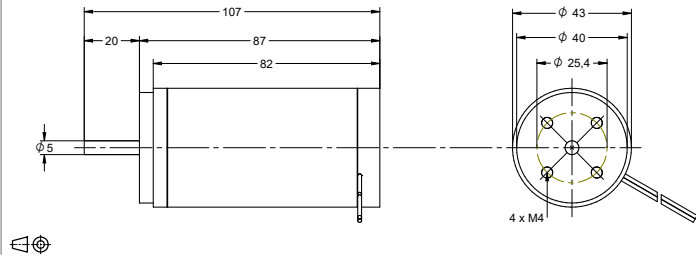

PHOTO



ADDITIONAL



Encoder

MODEL NO. DESIGNATIONS

MODEL - VOLTAGE - ME / OE

Example: D4387-12-ME

ME = Magnetic encoder
OE = Optical encoder

MOTOR DATA

Nominal voltage (V)	12	24
No load speed (rpm)	3600	4000
No load current (A)	1.00	0.50
Nominal speed (rpm) *	2700	3200
Nominal torque (mNm) *	44	44
Nominal current (A)	2.0	1.1
Stall torque (mNm)	167	176
Starting current (A)	7	4
Output (W)	13	15
Length (mm)	87	87

(*) Nominal speed and nominal torque have a tolerance of $\pm 15\%$